

TECHNICAL DATASHEET



REDUCED TEE 90°

03 Update - 04/2024

TECHNICAL DATA

Article No	001 115 0042 0288
d1 (mm)	280
d2 (mm)	110
L (mm)	690
le1 (mm)	146
le2 (mm)	87
Z (mm)	290
s1 (mm)	16,6
s2 (mm)	6,6
Weight (Kg)	13,280
Box Quantity (pcs)	1
Box Dimension (pcs)	50,5x70,5x33

IDENTIFICATION OF PRODUCT

D(mm)	280-110
SDR	17
RAW METARIAL	PE 100
PRESSURE CLASS	10 Bar Water 6 Bar Gas
TRADEMARK	NTG
EXECUTION	Injection Moulded
STANDARD	EN 12201-3 EN 1555-3 AS /NZS 4129

INJECTION MOULDED

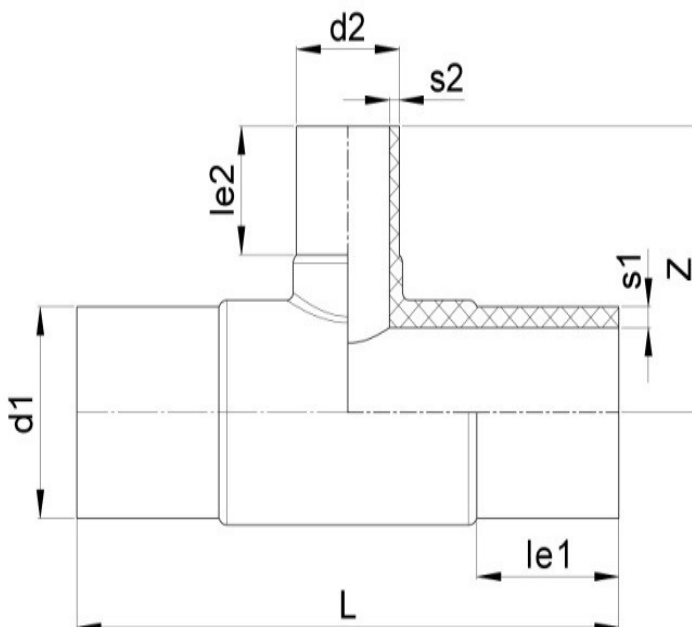

SPECIFICATION

Long Spigot

Tolerance on diameters and thickness according to the standards. The other dimensions are specialized. Tolerance $\pm 5\%$. NTG PLASTIK reserves all the right to change any information without giving prior notice. The production, distribution and utilization of this document without explicit authorization is prohibited.